

CANLink[®] CL-423-1XX Module Family I/O Module



The CL-423 is a solid-state microprocessor based module and member of the HED[®] CANLink[®] multiplexed control family. Delivered in a Deutsch enclosure, this unit provides a high density I/O count in a compact and economical package.

Designed for use as a stand alone unit or as part of a distributed system, the CL-423 is also available in a clear enclosure with LED indicators for each input for simple troubleshooting in the field.

The HED[®] CL-423 can be programmed using HED[®]'s do-it-yourself CANLink[®] Composer[™] programming tool or directly by HED[®] engineering, and is designed for use with the CANLink[®] Conductor[™] software tool for diagnostics and field troubleshooting.

9 Inputs and 4 Outputs including:

- (3) 3A PWM outputs with estimated current feedback
- (1) I/O hardware configurable as switch to battery input or 3A PWM outputs with estimated current feedback
- (3) switch to battery inputs
- (4) inputs hardware configurable as switch to ground, frequency or harness codes*
- (2) inputs hardware configurable as resistive sensor (RTD) or 10-bit analog
- (1) additional 10-bit analog input available if (2) above inputs are hardware configured for only 0 or 1 RTD inputs, not 2
- (1) USB Port
- (1) J1939 CAN port

Specifications	
Enclosure:	Deutsch standard EEC-325x4 PCB enclosure with 24-pin receptacle.
Mating Connectors: Deutsch	DTM06-12SA DTM06-12SB WM-12S (wedge) – Two needed (one per connector) 0462-201-20141 20AWG sockets 0413-204-2005 Sealing Plugs – Unused pins are required to be sealed to maintain module sealing
Operating Voltage Range:	8-32 VDC
Operating Temperature:	-40°C to 70°C
Storage Temperature:	-40°C to 85°C
IP Rating:	IP 6K9K (intended for either interior or exterior installation)
PC Boards:	The printed circuit boards are designed for high EMI/RFI protection. The boards are conformal coated with a silicone coating for further water/moisture protection. All inputs and outputs are protected against shorts to Battery(+) or Battery(-). 100% of the boards are functionally tested before shipment. * Harness codes are switch to ground inputs used to identify I/O module location and function to the master controller

CL-423 I/O Module

CL-423 I/O Module Pinout

DTM13-12PA (Gray)		DTM13-12PB (Black)	
Pin	Function	Pin	Function
1	BAT(-) Module	1	Input STB or Output DOUT(+)/PWM(+)/ECC(+)(3A)
2	Input STB	2	Input AIN/RTD
3	Input STB	3	Input AIN/RTD
4	Input STB	4	Input HID/STG/Freq
5	CAN-L	5	Input HID/STG/Freq
6	CAN-H	6	Input HID/STG/Freq
7	Input HID/STG/Freq	7	Input AIN
8	Output DOUT(+)/PWM(+)/ECC(+)(3A)	8	Shield
9	BAT(+) Outputs	9	USB (DM)
10	Output DOUT(+)/PWM(+)/ECC(+)(3A)	10	USB (DP)
11	Output DOUT(+)/PWM(+)/ECC(+)(3A)	11	BAT(+) Module and Outputs
12	BAT(+) Module and Outputs	12	BAT(-) Module

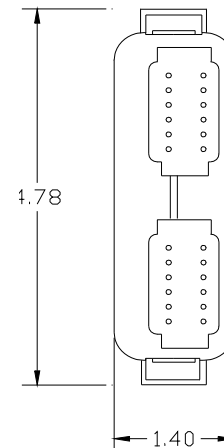
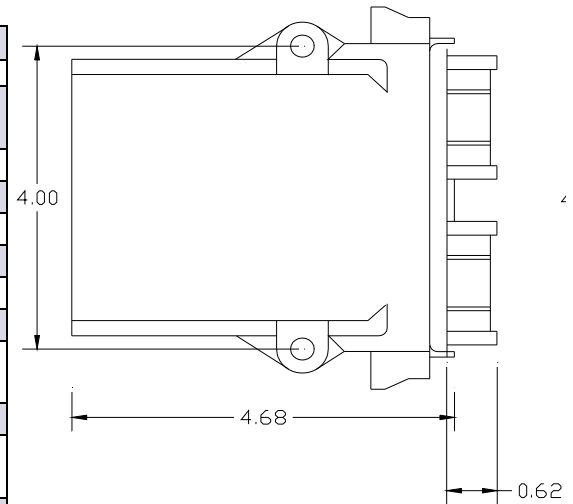

Note: Different I/O combinations are available. Please refer to specific CL-423-1XX data sheet for I/O number designations for use within Composer™. Data sheets available on HED® website.